



Construction Notice

Campus Drive Long-Term Pedestrian and Bicycle Detour

When: Beginning on or about November 11, 2019

Where: Campus Drive between the Paint Branch Trail and River Road

What: Beginning on or about November 11, 2019, the Purple Line will implement a long-term sidewalk closure on Campus Drive between the Paint Branch Trail and River Road. During the closure, a signed detour will be in place to guide bicyclists and pedestrians, that includes the use of stairs and elevators to cross the train tracks at the College Park Metro station. A paratransit service will be available for those who are unable to use the stairs at the College Park Metro station while the elevator is not operational. The paratransit service will operate Monday-Thursday from 11:30 p.m. to 5 a.m., Friday from 1 a.m. to 7 a.m., Saturday from 1 a.m. to 8 a.m. and Sunday from 11 p.m. to 5 a.m. Vehicles will operate in continuous loops alternating from one side of the closure to the other.

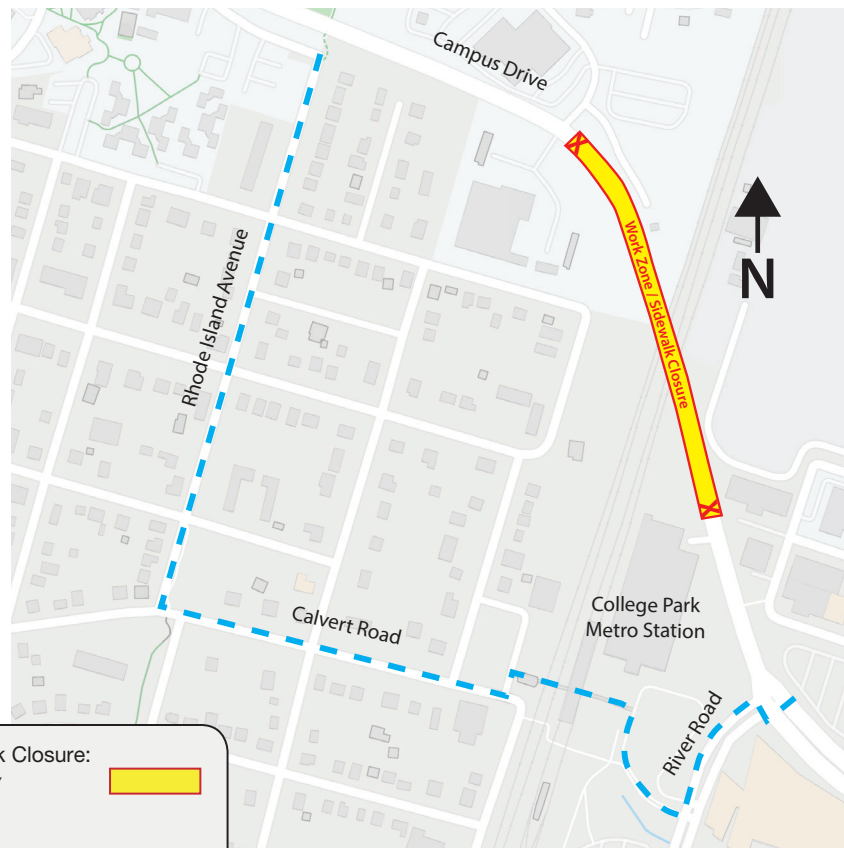

Work Zone / Sidewalk Closure:

Zona de construcción /
Cierre de acera:



Pedestrian Detour:

Desvío peatonal:



For information on construction activities and schedule,
contact the Purple Line at 240-424-5325 or visit www.purplelinemd.com.