

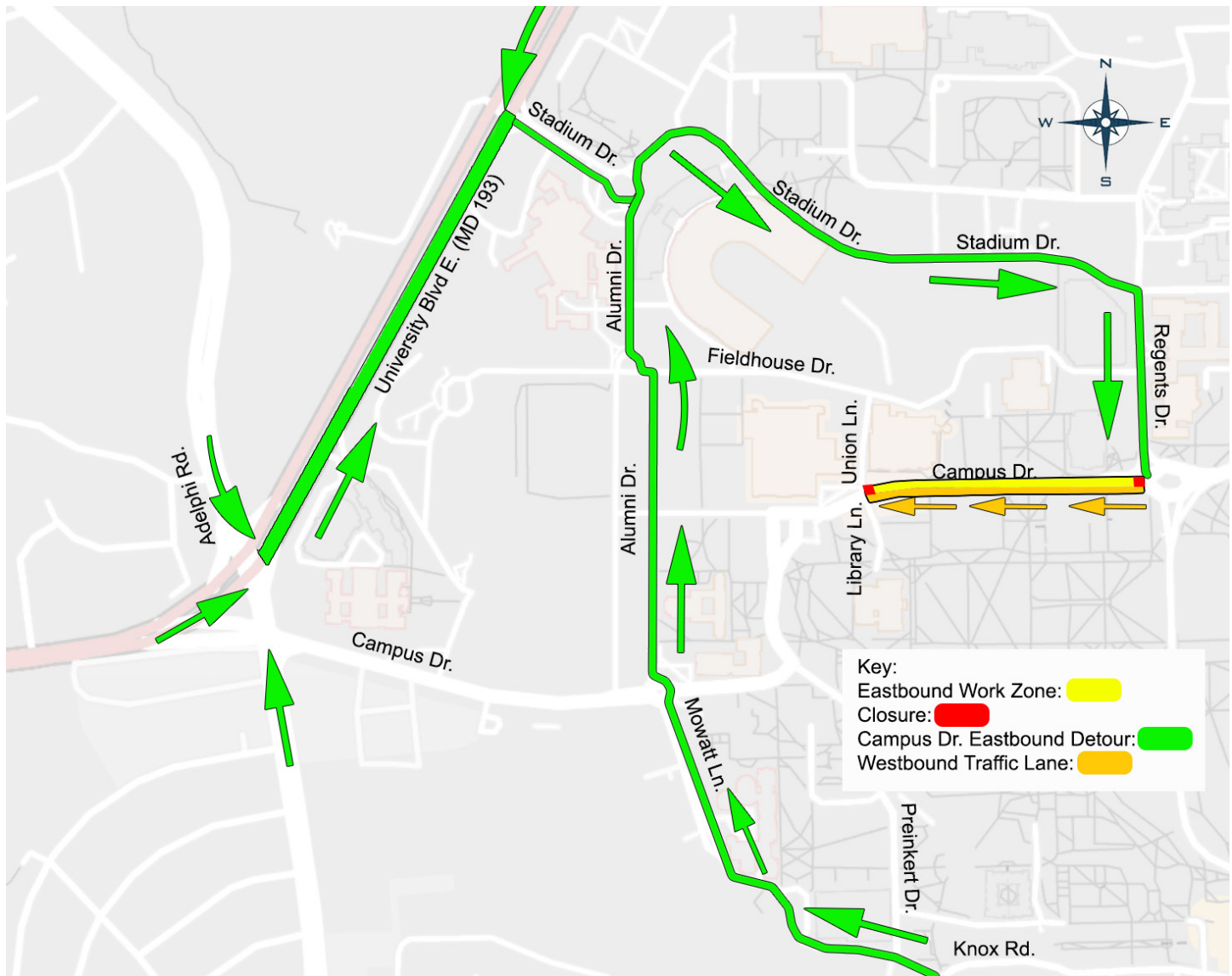

## Campus Drive Closure Detour

Beginning on or about August 26, 2018, the eastbound lane on Campus Drive, between Regents Drive and Library Lane will be closed permanently for construction. Westbound traffic will still flow normally during this closure. Drivers on University Boulevard E. (MD 193) will be directed to use Stadium Drive. Detour signage will be posted to direct drivers. **To stay up to date on construction work, sign up for construction notices at [purplelinemd.com](http://purplelinemd.com)**



### From University Blvd E. (MD 193)

Turn right onto Stadium Dr.  
 Enter traffic circle and bear left onto Stadium Dr.  
 Continue on Stadium Dr.  
 Turn right onto Regents Dr.

### From Mowatt Ln.

Continue through traffic circle onto Alumni Dr.  
 Continue straight on Alumni Dr.  
 Enter traffic circle and bear right  
 onto Stadium Dr.  
 Turn right onto Regents Dr.

For information on construction activities and schedule,  
 contact the Purple Line at 240-424-5325 or visit [www.purplelinemd.com](http://www.purplelinemd.com).