

PURPLE LINE

Art-in-Transit

Riverdale Park North-UMD

**David Franklin &
Aaron Whelton**

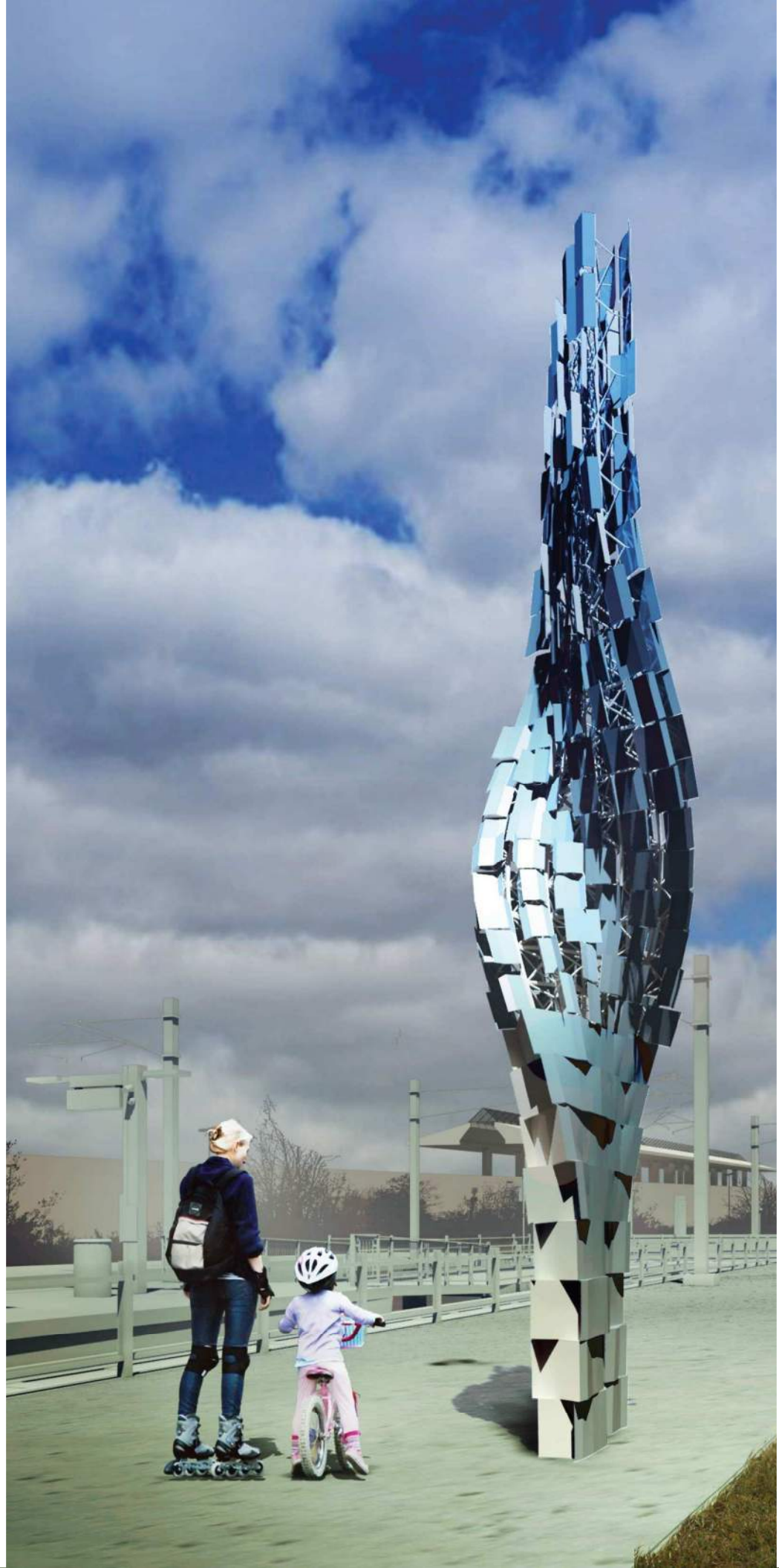

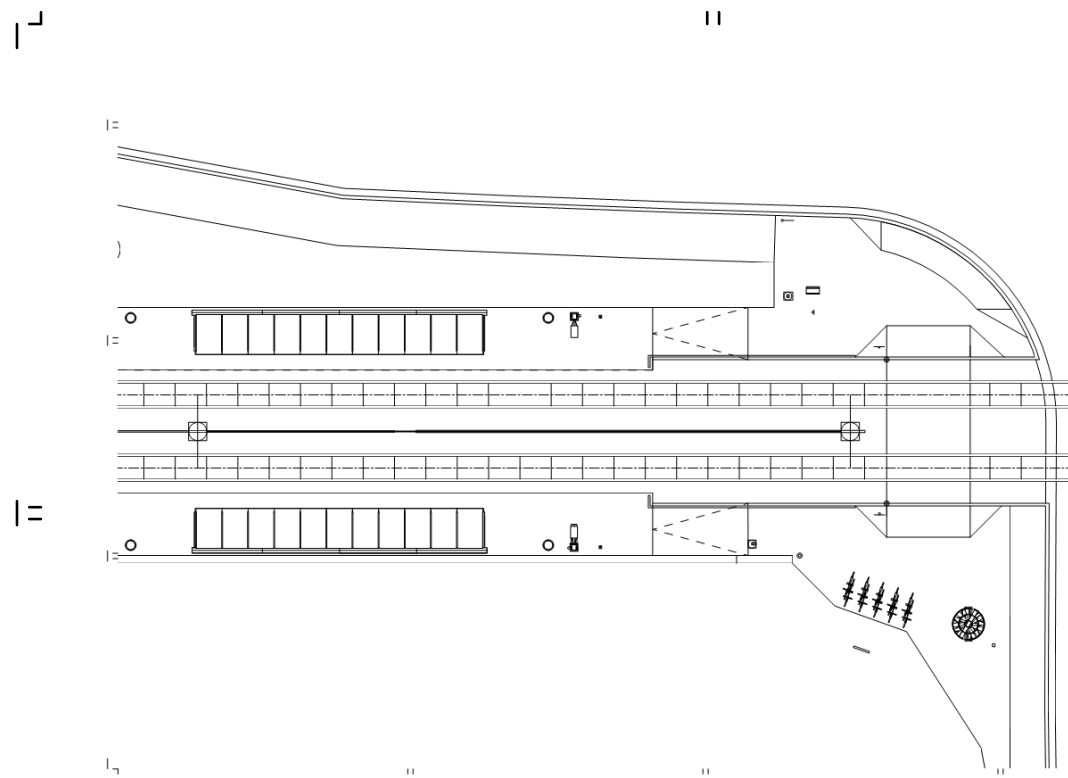

11

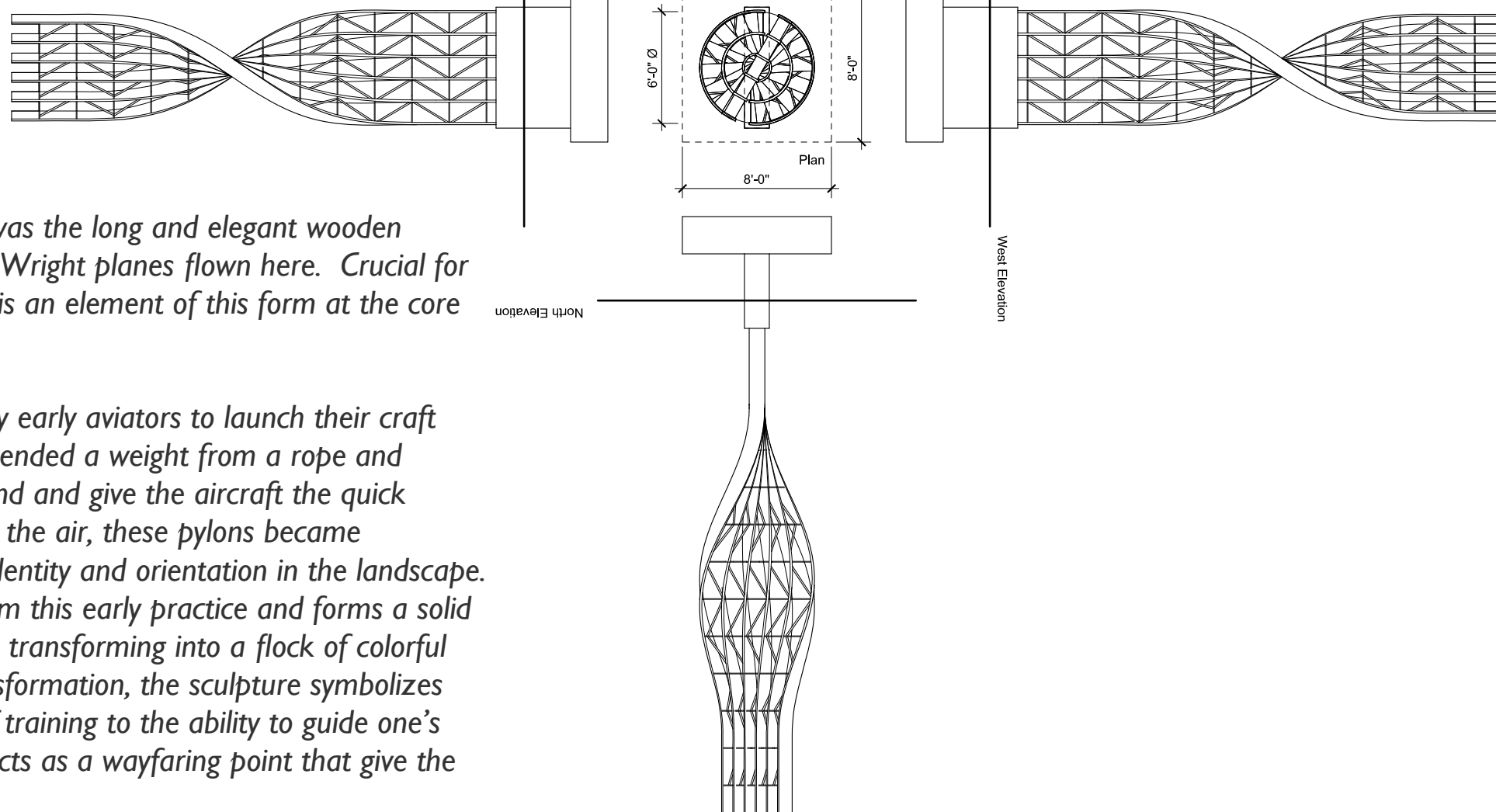

Nothing can ascend without lift, and it was the long and elegant wooden propellers that provided that for the early Wright planes flown here. Crucial for flight but also sculpturally beautiful, there is an element of this form at the core of our concept.

We were inspired by the pylons used by early aviators to launch their craft into the sky. These pyramidal frames suspended a weight from a rope and pulley. The weight would drop to the ground and give the aircraft the quick acceleration necessary for launch. Once in the air, these pylons became navigational markers for pilots providing identity and orientation in the landscape. Our pylon, Ascension, takes inspiration from this early practice and forms a solid base that transforms and twists as it rises, transforming into a flock of colorful ascending, winged shapes. With this transformation, the sculpture symbolizes the path of the student from the basics of training to the ability to guide one's own trajectory and soar. The pylon also acts as a wayfaring point that give the Station a unique identity.

D | F | A | W

David Franklin | Aaron Whelton
davidfranklinart.net | wheltonarch.com

PROJECT:

MSQ

NO.	DATE	ISSUE

KEY PLAN:

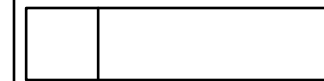

DRAWING: COMPOSITE DRAWING

ISSUE: _

ISSUE DATE: 05.01.2018

PROJECT #: 1701

SCALE: 1/4" = 1'-0"

DRAWING NUMBER:

A102